

"0.30-ACRE LOT LOCATED IN CHOUTEAU, OKLAHOMA"

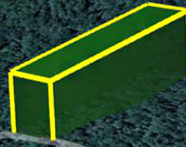

\$7,498

**006376-000285-000000 - 0.3 ACRES - S 337
RD, CHOUTEAU, OK 74337**

<https://agtpropertiesusa.com>

This 0.30-acre lot in the peaceful Lake Crest Subdivision offers the perfect setting for anyone looking to invest in their future. With room to build, you can design the home that fits your lifestyle—whether it's a mobile home, manufactured home, or a custom stick-built house. Plus, there's no HOA, giving you the freedom to enjoy...

- Oklahoma
- Cash Discount Price
- Available

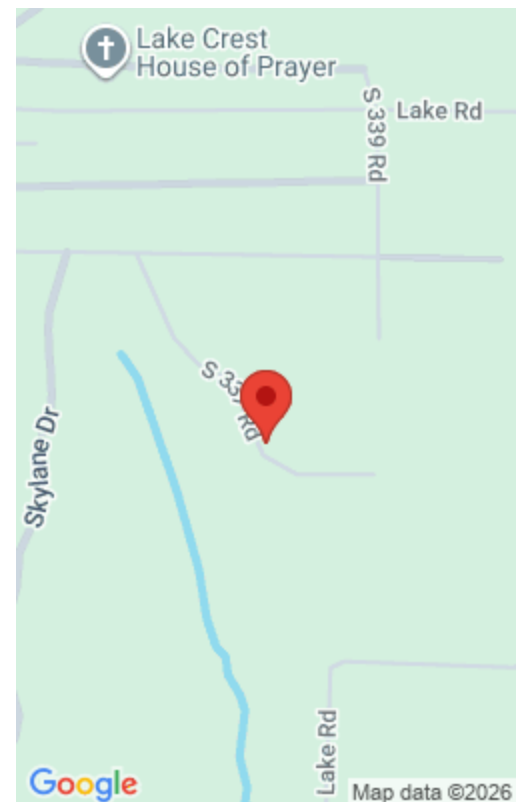

Basics

Parcel ID: 006376-000285-000000

Approx Dimensions: 54' x 245' x 57' x 260'

State: Oklahoma

Type: Oklahoma

Size: 0.30

County: Wagoner

Category: Cash Discount Price

Status: Available

Property Details

Cash Price: 7498

Term Option 2: \$250 down, \$250 for 33 months, for a total price of \$8,500

Google Map Link: [Driving Directions](#)

Northwest Corner: 36.0714, -95.2831

Southwest Corner: 36.0713, -95.2830

Legal Description: Lake Crest Lot 285

Terrain: Uneven

Power: Provided by Lake Region Electric Cooperative (918) 772-2526

Sewer: A Septic Tank is Required

RV Living: Not Allowed

Manufactured Homes: Allowed

Taxes Per Year: \$7.00

Conveyance: Warranty Deed

Term Option 1: \$200 down, \$200 for 44 months, for a total price of \$9,000

Term Option 3: \$350 down, \$350 for 22 months, for a total price of \$8,050

GPS Coordinates (center) at the road:
36.0717, -95.2822

Northeast Corner: 36.0717, -95.2823

Southeast Corner: 36.0716, -95.2822

Elevation: 710'

Access: Dirt Road

Water: Provided by Mayes Co RWD #2 ((918) 476-8992) or Well

Zoning: AG - Agriculture General District

Mobile Home Living: Allowed

POA: None

County Contact Information: For more information, call Wagoner County Planning & Zoning at: (918) 485-8123

